

STRONG ROOTS, NEW SEASON.

ST. AIDAN'S IN THE BEACH

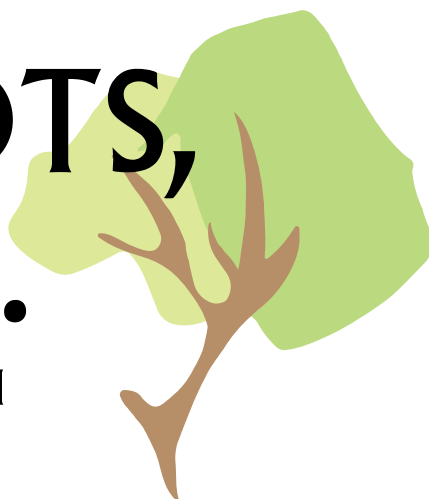

DECEMBER 2021

*Campaign Case
for Support*

ROOTED IN SERVICE

Our mission is to know Christ and to make Him known. All are welcome at St. Aidan's. We imagine St. Aidan's as a neighbourhood faith community, growing and changing with courage and hope, whose core values include a call to love our neighbour and care for the vulnerable; to engage boldly with our community; to care for God's creation; to strive for generosity in our ministries and an openness to life-long learning and spiritual growth.



Since 1890, St. Aidan's has built strong roots in the Beach. Originally a mission of St. John's Anglican Church in the Norway district, St. Aidan's was founded as a summer church for Toronto beachgoers. It served the neighbourhood without a building, before relocating to a tent and wooden pavilion until the present structure's completion in 1908. Memorial Hall was built following World War I to commemorate those who fought, including several parishioners. St. Aidan's continued to grow and evolve with community needs, such as providing daycare for working mothers during World War II.

St. Aidan's has remained a centre of community life to this day. In 2006, for instance, the parish developed its Out of the Cold program. By 2019, St. Aidan's would serve as many as seventy for dinner, while hosting twenty-five homeless men and women overnight. Carrying on a legacy of service and mission, St. Aidan's continues to build on its commitments to faithful inclusiveness, social justice, spiritual formation, environmental stewardship, and community engagement.

READY FOR A NEW SEASON

Today, our congregation has grown through community engagement programs and now has a wide, diverse population of all ages. Faithful to God's mission, over the past eight years, the St. Aidan's Mission & Facilities Committee has evaluated and planned for our long-term needs. With parish approval, we have embarked on a bold and innovative plan to redevelop, repair, and renovate our building.



The sale of Memorial Hall and vacant property—the generous legacy of generations past—funded the most critical aspects of this renovation. Those assets provided \$4.7M in funding that will have enabled us to:

- Create a warm and welcoming space, with an entrance off Queen Street, that is flexible to accommodate ministry and program expansion within the church for use seven days a week
- Be more environmentally efficient and sustainable, with lower energy consumption
- Expand accessibility, including adding an elevator, ramps, and other features

However, crucial elements of our vision for this new season of ministry remain unfunded and exceed the scope of that initial project. These key priorities include exterior masonry restoration, repair and restoration of our stained-glass windows, the landscaping of the West Garden and crucial support for expanding our ministry and outreach.

FIVE CORE INITIATIVES

This plan outlines essential elements to complete the renovation, undertake several restorative projects, and continue to build ministries and programs that are relevant for today's Beach and the broader community. The key elements and costs over a five-year period are highlighted below:

1. EXTERIOR MASONRY REPAIR & RESTORATION

Estimated Cost: \$300,000

The years of frost in winter and heat in the summer have caused mortar and brick deterioration on the church's outside walls. Essential repair will help the building retain its heat in the winter and ensure that its exterior remains sound for future parishioners.

2. STAINED GLASS CONSERVATION & RESTORATION

Estimated Cost: \$200,000

Repairing and restoring our beautiful stained-glass windows will protect them from further exposure to the harmful elements of cold, rain, snow, and ultraviolet light. The four large windows, twelve small rectangle windows, and windows in the stairwell are all showing varying degrees of deformation, which will need to be addressed by reputtying and some leadwork. The lovely and rare Southwest Dalle de Verre windows are holding up well, but in the long-term, they will need vented ultraviolet exterior protection.



3. A RE-VISIONED WEST GARDEN

Estimated Cost: \$100,000

Incorporating Care of Creation practices, our re-visioned West Garden will provide accessible, soul-restoring space for outdoor worship, gathering together, meditation, and a natural children's play area for both the parish and community at large. The existing mature oaks (which are a keynote species) and lush maples will be a focal point for the garden as will a bioswale for stormwater management.

Professionally designed on a pro-bono basis by Bruce Mori and landscape architects at the IBI group, the West Garden is imagined to be a complementary adjunct to the newly renovated indoor space. Revised concept drawings (right) incorporate several design elements from their in-house competition.

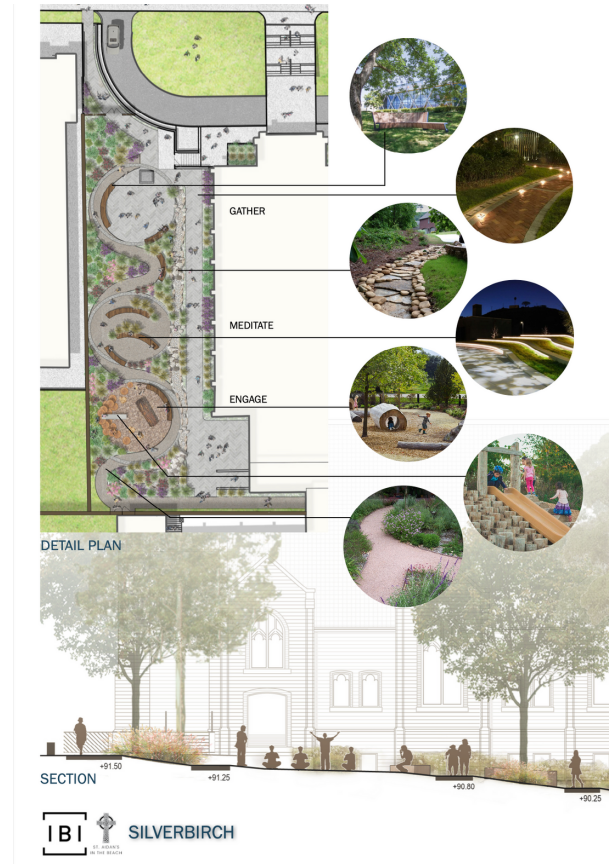

4. CONTINUED FUNDING OF AN ASSOCIATE PRIEST

Estimated Cost: \$100,000

The ministry of an Associate Priest contributes significantly to community life. Currently, this position is only partially funded through a diocesan grant. Our plan for growing the congregation is to support this position through bridge funding (i.e. the estimated cost) so as to sustain it on an ongoing basis through the parish budget. Current priorities for an Associate Priest include:

- Growing and supporting small groups within the parish community
- Developing innovative courses for new Christians and seekers
- Providing support for lay leaders involved in family ministries, such as church school, youth ministry and Beach Zipline
- Training lay leaders in outreach ministries that engage the Beach community
- Developing media such a podcasts for adult education and outreach
- Exploring interfaith dialogue opportunities locally

5. AN EXPANDED YOUTH MINISTRY

Estimated Cost: \$50,000

One mark of a vibrant church is having a mission that looks outward. The young family and youth demographic is growing within our parish and the broader Beach community. Providing increased funding for youth programs will allow us to meet these challenges by building this vital ministry. Current priorities include:

- Encouraging youth in the parish and community to take part in our ministries and outreach opportunities
- Supporting both traditional and innovative youth programming, including Sunday programming and Beach Zipline
- Supporting the development of youth leadership through youth led initiatives
- Identifying growth opportunities for St. Aidan's by understanding the gaps in youth programming and/or space access in the broader Beach community
- Supporting cross-ministry opportunities for youth to engage in the parish



YOUR FAITHFUL SUPPORT IS NEEDED

*“...and now I have seen with joy how willingly your people
who are here have given to you”*

1 Chronicles 29:17 NIV

These core initiatives represent a call to care for the spaces that reflect our heritage and situate our worship together—as well as a challenge to extend that care outward into sustainable new communities and spaces for generations to come. With roots firmly planted, we envision a future in which St. Aidan's stands as a place of nourishment and stability, arising into a daring new season of faithfulness. Our church will thereby provide rich opportunities for worship and spiritual growth as part of a lively, engaged community committed to social and environmental justice.

Thank you for taking the time to read this Case for Support. Please consider giving towards and praying for this campaign effort. Your participation, at any level, is appreciated!

FINANCIAL PLANS

2022-2026

REPAIRS & RENOVATIONS	YEAR(S) NEEDED	ESTIMATES
Exterior Masonry Repair & Restoration	2022-2024	\$300,000
Stained Glass Repair & Restoration	2023-2026	\$200,000
West Garden Lanscaping	2023	\$100,000
EXPANDING MINISTRY & OUTREACH		
Associate Priest	2023-2026	\$100,000
Youth Ministry	2022-2023	\$50,000
TOTAL COST*		\$750,000
ADDITIONAL SOURCES OF FUNDING**		
Operating Surplus	2022-2026	\$100,000
St. Aidan's Endowment Fund	2025-2026	\$180,000
CAMPAIGN GOAL		\$500,000

*These costs are estimates and are thus subject to change based on a multitude of factors. However, we believe these numbers to be appropriate enough for our capital planning purposes.

**Over the next five years, St. Aidan's projects an operating surplus available to contribute to capital spending needs. Additionally, St. Aidan's maintains an investment fund that, in the past, has been available to support church initiatives both in terms of operating and capital shortfalls on a case by case basis.

As always, St. Aidan's leadership will communicate to vestry should a re-prioritization of capital spending be required during and after the campaign.

STRONG ROOTS, NEW SEASON.

St. Aidan's in the Beach